



Festival of Music 2012

Sponsored by the

NORTHSHORE CONCERT BAND

**With funding by the
Farny R. Wurlitzer Foundation
and the Illinois Arts Council**



**Northwestern University Campus—Evanston, Illinois
March 15-17, 2012**



To All Festival Attendees:

We would like to welcome you to our 36th annual festival of music and to thank you for your participation, whether you are a student contestant, a parent, an ensemble director/private instructor, or a patron of good music. Part of our mission as a community band is *"to assist in the music education of young people—the future generation of adult musicians."* We believe fervently in the concept of a *"lifetime of music"* and that it begins with young people displaying their musical talents as you will hear today.

This year, the Northshore Concert Band would like to thank the Farny R. Wurlitzer Foundation for its generous contribution of \$5,000 to the band for the annual Festival of Music, held in conjunction with the Northwestern University School of Music. Each year, over 3000 Chicago-area students participate in band clinic sessions, perform solos and ensembles, and attend master classes, recitals and a Northshore Band concert. The Wurlitzer Foundation contribution helps support this unique opportunity for student musicians.

We hope that you will have a rewarding musical experience during this three-day festival and that you will continue to participate in the festival in future years.

Sincerely,

Rob Yapple
Festival Manager
Northshore Concert Band

Kendra Gohr
Data/Scheduling Manager
Northshore Concert Band

Thirty-Sixth Annual Festival of Music

Northwestern University School of Music Administration

Toni-Marie Montgomery	Dean of School of Music
René Machado	Associate Dean for Administration & Finance
Linda Garton	Assistant Dean for Student Affairs
Mallory Thompson	Director of Bands
Timothy Robblee	Associate Director of Bands
Dan Farris	Director of Athletic Bands
Richard Van Kleeck	Director Concert Activities
Jim Sheppard	Department Assistant for Band
Mathew Lake	Information Management Analyst
Melissa Hoppe	Administrative Assistant

Festival Staff

Mallory Thompson	Artistic Director
Rob Yapple	Festival Manager
Kendra Gohr	Festival Data/Scheduling Manager
Melissa Hoppe	Facilities Coordinator
Jim Sheppard	Associate Facilities Coordinator

Northshore Concert Band Board of Directors and Staff

Laura Stibich	Board Chair
David Zyer	Board Vice-Chair
Mallory Thompson	Artistic Director
Dan Farris	Assistant Conductor
Jennifer Young	Business Manager
Greg Glover	Secretary
Deborah Hawes	Treasurer
Debbie Durham	Personnel Director
Paul Bauer	Director of Development
Julie Wolf	Marketing & Development Manager
Ann Motogawa	Marketing & PR Director
Meghan Bautista	Librarian
Rob Yapple	Festival Manager & Administrative Assistant
Kendra Gohr	Festival Scheduling Manager
Traci Bowering	Member at Large
Kathryn Cargill	Member at Large
Nancy Golden	Member at Large
Gail Kalver	Member at Large
Erin Foster	Member at Large
Ryan Sedgwick	Member at Large
Todd Smith	Member at Large

Festival Foodservice 2012

Foodservice at the Norris Center will be available Thursday and Friday from 10:00AM - 3:00PM. Listed below are menu selections and hours for Saturday.

If you plan on your students eating at Norris, please e-mail

ryaple@northshoreband.org with the day, time, restaurants, and approx. number of diners. This will help Norris prepare the right amount of food and have staff ready at the right times. **Please get this information to Rob as soon as possible (no later than March 2nd) to ensure supply orders and staffing.** No outside food is to be brought into or consumed in Norris Center.

Saturday hours:

Paws 'n Go C-Store

8:00am - 3:00pm

A convenience store with standard fare (variety of beverages, snack foods, sweets, yogurt, frozen foods, etc.)

The Simply-to-Go section of the C-Store has pre-made sandwiches, wraps, fresh-cut fruit, cheese, etc.

Breakfast items such as cereal cups, bars, coffee cake, fruit, etc. are available.

Willie's Food Court

11:00am-2:00pm

The Grill and The Wok will both be open, but with limited menus.

The Grill will have prepared hamburgers/cheeseburgers, chicken tenders, grilled cheese sandwiches, and french fries. The Wok will have pre-made dishes.

Sbarro Pizza

11:00am-2:00pm

Sbarro will have a limited menu consisting of cheese, pepperoni, and veggie pizzas.

Thirty-Sixth Annual Festival of Music

Northwestern University Campus - Evanston, Illinois

GENERAL INFORMATION

LOCATION

The School of Music of Northwestern University is located in Evanston. Interstate Routes 94 and 294 are the fastest routes from the North and South and Illinois Routes 58 and 14 from the West. Please consult the enclosed maps for detailed directions.

PARKING

If you have parents who accompany students to clinics **Thursday and Friday** and park their cars in Northwestern University parking lots, they must have a parking pass (Thursday and Friday only). This can be purchased at 1819 Hinman Avenue from 8-5 (**cash only**). **CARS WITHOUT PASSES ARE SUBJECT TO EXPENSIVE FINES AND TOWING.**

The parking facility for Pick-Staiger/Regenstein/Norris Center will provide ample automobile parking on Saturday. You may want to instruct those who are driving to unload contestants, instruments and equipment at Pick-Staiger and allow time to find a parking space.

PLEASE NOTE THAT YOU ARE NOT ALLOWED TO PARK IN THE CIRCLE DRIVE BY PICK-STAIGER/ REGENSTEIN/NORRIS CENTER AT ANYTIME DURING THE THREE DAY FESTIVAL.

It will be necessary to have all school buses unload equipment and students at Pick-Staiger and get parking directions from your greeter (buses may not leave engines running). Directors, please instruct bus drivers accordingly. **BUSES MAY NOT PARK BY PICK-STAIGER/REGENSTEIN/NORRIS CENTER.**

LOCATION OF BUILDINGS

The following buildings will be in use for the Festival and are indicated on the campus map for further identification:

◆ Pick-Staiger Concert Hall

◆ Regenstein Hall

◆ Norris University Center

INFORMATION CENTERS

On Saturday there will be an information center and guides at the main entrance of each building to assist you and your students in finding room locations.

CLINIC BANDS

A schedule for the clinic bands is enclosed. Directors will please make special note of the time schedule. Your cooperation on this point is absolutely essential if each organization is to receive the full clinic time. You will be greeted at your buses by NU students. They will guide you to the performance center.

A set-up crew will be on hand to assist in seating arrangements for each organization, and guides will assist you in moving your group from the rehearsal area to the clinic stage. **Clinic directors: please provide a set of scores for the clinician.**

CLINIC BANDS (continued)

Equipment available to all clinic bands:

WARM-UP ROOM

Music stands and chairs
4 Timpani
Bass Drum
Suspended cymbals

CLINIC ROOM

Music stands and chairs
4 Timpani
Bass Drum
Cymbals
Suspended cymbals
Bells
Chimes
Xylophone
Vibes
Marimba

PARTICIPATING SCHOOLS AND CODE NUMBERS

All schools entered in the Festival have been given a code number. Events of each school are listed under the code number rather than by school name.

INSTRUMENT STORAGE

Space will be available for checking instruments in Regenstein Room 038. Directors will please instruct students not to take instrument cases to the contest rooms. There just isn't enough space in the rooms or hallways of Regenstein.

WARM-UP ROOMS

Students participating in the solo and ensemble events may warm-up in the practice rooms on the first floor of Regenstein and the band room (011.) In Norris, vocal events may use the Big Ten room (104) on the first floor and string events may use the Louis Room (205) on the second floor.

SOLO AND ENSEMBLE EVENTS

Students must provide an original of the solo or ensemble score for the adjudicator. Photocopies of a solo or score are illegal and will not be accepted. Measures must be numbered. Failure to meet these requirements will result in the lowering of the final rating one level. **A COPY MACHINE WILL NOT BE AVAILABLE ON THE DAY OF THE FESTIVAL.**

SOLO AND ENSEMBLE TIME CONFLICTS

There will undoubtedly be conflicts with accompanists scheduled for more than one player at a time. Contestants should report to the designated contest room at the scheduled time and should wait until his accompanist arrives. When his event number is called, he should notify the judge that he is waiting for his accompanist and will perform when the accompanist arrives.

PERCUSSION EQUIPMENT AVAILABLE TO SOLO AND ENSEMBLE ENTRIES

Bass Drum
Chimes
Drum set

Bells
Xylophone

Marimba
Vibes

Suspended Cymbals
4 Timpani

Master Time Schedule – 2012

Saturday, March 17th Solo/Ensemble

8:00 a.m.	Solo and Ensemble Events Begin Regenstein Hall & Norris Center
9:00 a.m. – 9:50 a.m.	Instrumental Master Classes Regenstein Recital Hall (flute) Norris 101 – Wildcat Room (tpt)
10:00 a.m. – 10:50 a.m.	Instrumental Master Classes Regenstein Recital Hall (clarinet) Norris 101 – Wildcat Room (low brass)
11:00 a.m. – 11:50 a.m.	Northshore Band Member Recital Regenstein Recital Hall
12:00 p.m. – 12:50 p.m.	Northshore Concert Band Concert Pick–Staiger Concert Hall
1:30 p.m.	Solo and Ensemble Events Continue Regenstein Hall & Norris Center
4:45 p.m.	Solo and Ensemble Events Conclude

Recital Program

Regenstein Recital Hall

Saturday, March 17, 2012
11:00 a.m. - 11:50 a.m.

This recital will feature a variety of instrumental solos and ensembles performed by Northshore Concert Band members. The program will be available at the recital hall on the day of the performance.

Master Classes

9:00am - 9:50am

Flute - Regenstein Recital Hall
Trumpet - Norris 101 (Wildcat Room)

10:00am - 10:50am

Clarinet - Regenstein Recital Hall
Low Brass - Norris 101 (Wildcat Room)

2012 Festival Rooms

Regenstein Hall

<u>Room #</u>	<u>Instrument(s)</u>	<u>Location</u>	<u>Time</u>
Regenstein 011	Wind/percussion warm-up	Basement	8:00-5:00
Regenstein 038	Oboe & Bassoon Solos/Ens	Basement	8:00-3:00
Regenstein 058	Saxophone Solos/Ensembles	Basement	8:00-4:30
Regenstein 059	Flute Solos	Basement	8:00-3:30
Regenstein 067	Flute Solos/Ensembles	Basement	8:00-4:45
Regenstein 117	Horn Solos/Ensembles	First Floor	8:30-3:30
Regenstein 119	Trumpet Solos/Ensembles	First Floor	8:00-4:45
Regenstein 121	Percussion Solos/Ensembles	First Floor	8:00-3:30
Regenstein 137	Trumpet Solos/Ensembles	First Floor	8:00-4:00
Regenstein 139	Trombone Solos/Ensembles	First Floor	8:00-3:30
Regenstein 143	Tuba & Euph Solos/Ensembles	First Floor	8:00-3:00
Regenstein 156	Flute Solos	First Floor	8:00-4:45
Regenstein 158	Saxophone Solos/Ensembles	First Floor	8:00-4:30
Reg Recital Hall	Master Classes/Recital	First Floor	9:00-11:30
Regenstein 245	Piano Solos	Second Floor	8:00-4:45
Regenstein 212	Piano Solos/Ensembles	Second Floor	8:00-5:00
Regenstein 214	Piano Solos	Second Floor	8:00-4:45
Regenstein 220	Piano Solos	Second Floor	8:00-4:15
Regenstein 234	Piano Solos/Ensembles	Second Floor	8:00-4:45
Regenstein 243	Piano Solos	Second Floor	8:00-4:45
Regenstein 244	Piano Solos	Second Floor	8:00-11:45
Regenstein 250	Clarinet Solos/Ensembles	Second Floor	8:00-5:00
Regenstein 259	Clarinet Solos/Ensembles	Second Floor	8:00-5:00
Regenstein 260	Clarinet Solos/Ensembles	Second Floor	8:00-11:30

Norris University Center

Norris 101 (Wildcat)	Brass Masterclass	First Floor	8:00-11:30
Norris 102 (Evans)	Vocal Solos	First Floor	8:00-3:30
Norris 103 (Chicago)	Vocal Solos	First Floor	8:00-3:30
McCormick Aud.	Vocal Ensembles	First Floor	8:00-4:00
Norris 104 (Big Ten)	Vocal Warm-up room	First Floor	8:00-4:00
Norris 201 (1851)	String Solos/Ensembles	Second Floor	8:00-4:00
Norris 202 (NW)	String Solos/Ensembles	Second Floor	8:00-4:00
Norris 203 (Lake)	String Solos/Ensembles	Second Floor	8:00-12:00
Norris 204 (Scholars)	String Solos/Ensembles	Second Floor	8:00-4:00
Norris 205 (Louis)	String Warm-Up room	Second Floor	8:00-4:00

NCB Festival of Music 2012 Participating Instructors and Code Numbers

Adam Gohr	49	Jim Kasprzyk	33	Peter Rosheger	20
Alla Gorelik	90	Jo Ellen Madden	66	Priscilla G. Mendoza	48
Andrew Hunter	32	John Harshey	88	Rachael Hartmann	59
Andrew Messerli	2	John P. Timmins	10	Renee Brown	57
Andrew T. Carpenter	78	John Temmerman	55	Renee DeJager	81
Andria Anderson	4	Joshua Huppert	102	Richard E. Stiles	83
Ann Dufek	73	Joy Forman	19	Richard G. Faller	71
Ann Lingner	69	Joy Yu Hoffman	77	Richard W. Faller	72
Barbara Anderson	13	Judy Krugman	5	Rizelle Capito	56
Beata Berlin	104	Julian B. Arron	28	Rodney Owens	103
Beatriz Helguera-Snow	52	Karen Kurtz	68	Roy Hansen	43
Betty Garrett	96	Karen Olsen	30	Scott A Oliver	8
Bill Seliger	95	Kathleen Rose	75	Steve Klaus	91
Birdi Dawson	82	Kathy Heetland	34	Steven A. Stenzel	22
Bonnie Campbell	84	Kendra Gohr	70	Steven Katz	31
Brad Rychecky	25	Kevin Wood	80	Susan Swartz	100
Brian Jacobi	38	Kristina Sandrock	76	Susan Vaughan	74
Brian K. Wilson		Laura Blanchard	87	Suzanne Senese	17
& Daniel J. Singer	86	Laurel Kaiser	97	Terese Parisoli	106
Candi Horton	101	Lisa Bishoff	35	Theresa Lams	41
Carol Janossy	63	Lynd Corley	24	Timothy Loest	9
Carolyn Sanderson	26	Mandy Habel Ramsey	107	Traci Bowering	7
Chip Braker	1	Maria B. Irabagon	64		
Christina Heath	37	Mark Dahl	45		
Cristina Brown	92	Marlene Chatain	79		
David W. Fivecoate	14	Marlene Molewyk	61		
Debbie Crouse	16	Martin Kalas	11		
Diana O'Connor	89	Mary Beth Molenaar	53		
Diana Schmuck	58	Matt Temple	23		
Diane Willis	109	Matthew Kastor	36		
Don Golden	6	Matthew Moore	50		
Donna Curry	46	Michael J. Ross	21		
Doreen Oleszczuk	18	Mike Chiodo	44		
Dr. Andrea Schneider	47	Mike Madonia	27		
Eliza Krivo	93	Nancy M. Hinners	15		
Ellenore Bonebrake	67	Nancy Magill	65		
Emily Binder	3	Nicholas C Cagle	42		
Eric Bachmann	12	Nina Wallenberg	105		
Euri A. Martinez	29	Patricia Bartell	40		
Greg Wojcik	51	Patricia Schneider	39		
Haymee Ann	60	Patricia White	99		
Heidi Helstad	98	Patrick Dawson	85		
Jennifer Nelson	62	Paula Fischer	94		

Festival of Music

March 17, 2012

Solo and Ensemble Rules for the 2012 Festival

1. All entry forms should be **typed** (or printed very clearly).
2. Each solo and ensemble must have an entry form. Each Director/Private Instructor must return their entry forms and fee form with **one** check. Individual student/parent checks will not be accepted and will be returned as invalid.
3. Requests for a specific performance time (A.M. or P.M.) will be limited to five (5) per school and **MUST** be requested on the entry form when submitted.
4. No changes in performance times will be made after the entry form is submitted. In the event of a conflict with other school activities such as a science fair, an athletic event, a spelling bee, etc., students will have to choose in which event they will participate.
5. Switching performance times within your own school groups is not allowed. Students will be disqualified from the competition if this rule is violated.
6. Additions to the contest schedule will not be made after the book is in print. Directors must be absolutely sure to include all entries when the entry forms are submitted.
7. Directors **MAY NOT** substitute a new entry in place of a cancellation.
8. Entry fees will not be refunded for cancellations reported after the entry form is submitted.
9. Directors and private teachers must attend on the day of the Festival to assist in the supervision of the students.
10. Students must provide an **ORIGINAL** of the solo or ensemble score for the adjudicator. Photocopies of a solo or score are illegal and will not be accepted. **Measures must be numbered.** Failure to meet these requirements will result in the lowering of the final rating one level. **A COPY MACHINE WILL NOT BE AVAILABLE ON THE DAY OF THE FESTIVAL.**
11. Solo and ensemble performances must not exceed six minutes.
12. Vocal students may sing two selections provided they are no longer than the six minute performance time.
13. No penalty shall be assessed for lack of an accompaniment. However, if the accompaniment is an integral part of the solo the judge may take this into consideration in the final rating.
14. Music does **not** need to be memorized.
15. If you are submitting more than one entry of a specific type of ensemble, each entry may be numbered. Example: Flute Duet #1; Flute Duet #2; Flute Duet #3, etc.

Last Name	First Name	School	Date	Day	Warm up	Clinic	Clinician	Location
Temple	Matt	New Trier H.S.	3/15/12	Thursday	7:30	8:00	Thompson	Pick-Staiger
Moore	Matthew	Fremd H.S.	3/15/12	Thursday	8:00	9:00	Thompson	Pick-Staiger
Braker	Chip	Forreston H.S.	3/15/12	Thursday	9:00	10:00	Thompson	Pick-Staiger
Farmer	Matt	Mundelein H.S. Symphonic Band (2)	3/15/12	Thursday	10:00	11:00	Thompson	Pick-Staiger
Gohr	Adam	Mundelein H.S. Wind Ensemble (1)	3/15/12	Thursday	11:00	12:00	Thompson	Pick-Staiger
Wilson	Brian	Oskosh West H.S. Wind Ensemble	3/15/12	Thursday	12:00	1:00	Thompson	Pick-Staiger
Wojcik	Greg	Glenbrook South H.S. (1)	3/15/12	Thursday	1:00	2:00	Farris	Pick-Staiger
Wojcik	Greg	Glenbrook South H.S. (2)	3/15/12	Thursday	2:00	3:00	Robblee	Pick-Staiger
Owens	Rodney	Daniel Wright J.H.S.	3/15/12	Thursday	7:30	8:00		Regenstein
Stiles	Richard	Richmond-Burton Comm. H.S. (1)	3/15/12	Thursday	9:15	9:45	Robblee	Regenstein
Stiles	Richard	Richmond-Burton Comm. H.S. (2)	3/15/12	Thursday	11:00	11:30	Farris	Regenstein
			3/15/12	Thursday	12:45	1:15	Robblee	Regenstein
			3/15/12	Thursday	2:30	3:00		Regenstein
			3/15/12	Thursday	4:15	4:45		Regenstein
Dufek	Ann	Wilmette J.H.S.	3/16/12	Friday	7:30	8:00	Farris	Pick-Staiger
Iwinski	Mark	Victor J. Andrew H.S.	3/16/12	Friday	8:00	9:00	Farris	Pick-Staiger
Dahl	Mark	Lyons Township H.S.	3/16/12	Friday	9:00	10:00	Thompson	Pick-Staiger
Ross	Michael	Appleton West H.S.	3/16/12	Friday	10:00	11:00	Thompson	Pick-Staiger
Harshey	John	West Oak M.S.	3/16/12	Friday	11:00	12:00	Robblee	Pick-Staiger
Madonia	Mike	TF South H.S.	3/16/12	Friday	12:00	1:00	Thompson	Pick-Staiger
Cagle	Nicholas	Yorkville H.S.	3/16/12	Friday	1:00	2:00	Thompson	Pick-Staiger
Kastor	Matthew	Lakes Community H.S.	3/16/12	Friday	2:00	3:00	Thompson	Pick-Staiger
			3/16/12	Friday	7:30	8:00		Regenstein
Hansen	Roy	Robert Frost J.H.S.	3/16/12	Friday	9:15	9:45	Robblee	Regenstein
Golden	Donald	Sunset Ridge School	3/16/12	Friday	11:00	11:30	Farris	Regenstein
Stenzel	Steve	Lake Zurich M.S. North	3/16/12	Friday	12:45	1:15	Farris	Regenstein
Rychecky	Bradley	Matthews M.S.	3/16/12	Friday	2:30	3:00	Robblee	Regenstein
Hunter	Andrew	Wauconda M.S.	3/16/12	Friday	4:15	4:45	Robblee	Regenstein
Bachmann	Eric	Emerson M.S.	3/17/12	Saturday	8:00	8:30	Robblee	Pick-Staiger
Timmons	John	Crone M.S.	3/17/12	Saturday	8:30	9:30	Robblee	Pick-Staiger
Binder	Emily	Gregory M.S.	3/17/12	Saturday	9:30	10:30	Robblee	Pick-Staiger
Oliver	Scott	Hinsdale M.S.	3/17/12	Saturday	1:00	1:30	Farris	Pick-Staiger
Loest	Tim	Peacock M.S.	3/17/12	Saturday	1:30	2:30	Farris	Pick-Staiger
Jacobi	Brian	Lincoln M.S.	3/17/12	Saturday	2:30	3:30	Farris	Pick-Staiger

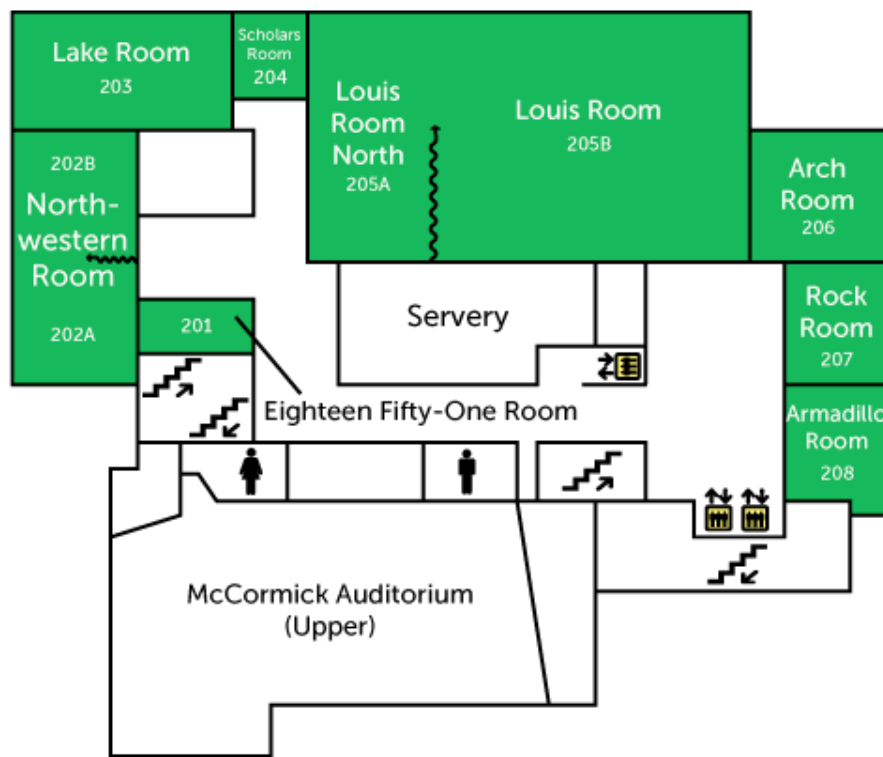

Norris - Second Floor



Norris - First Floor