

Sketching and Dimensioning Terms

Pictures on Monday's test will be very similar to those used
In this presentation

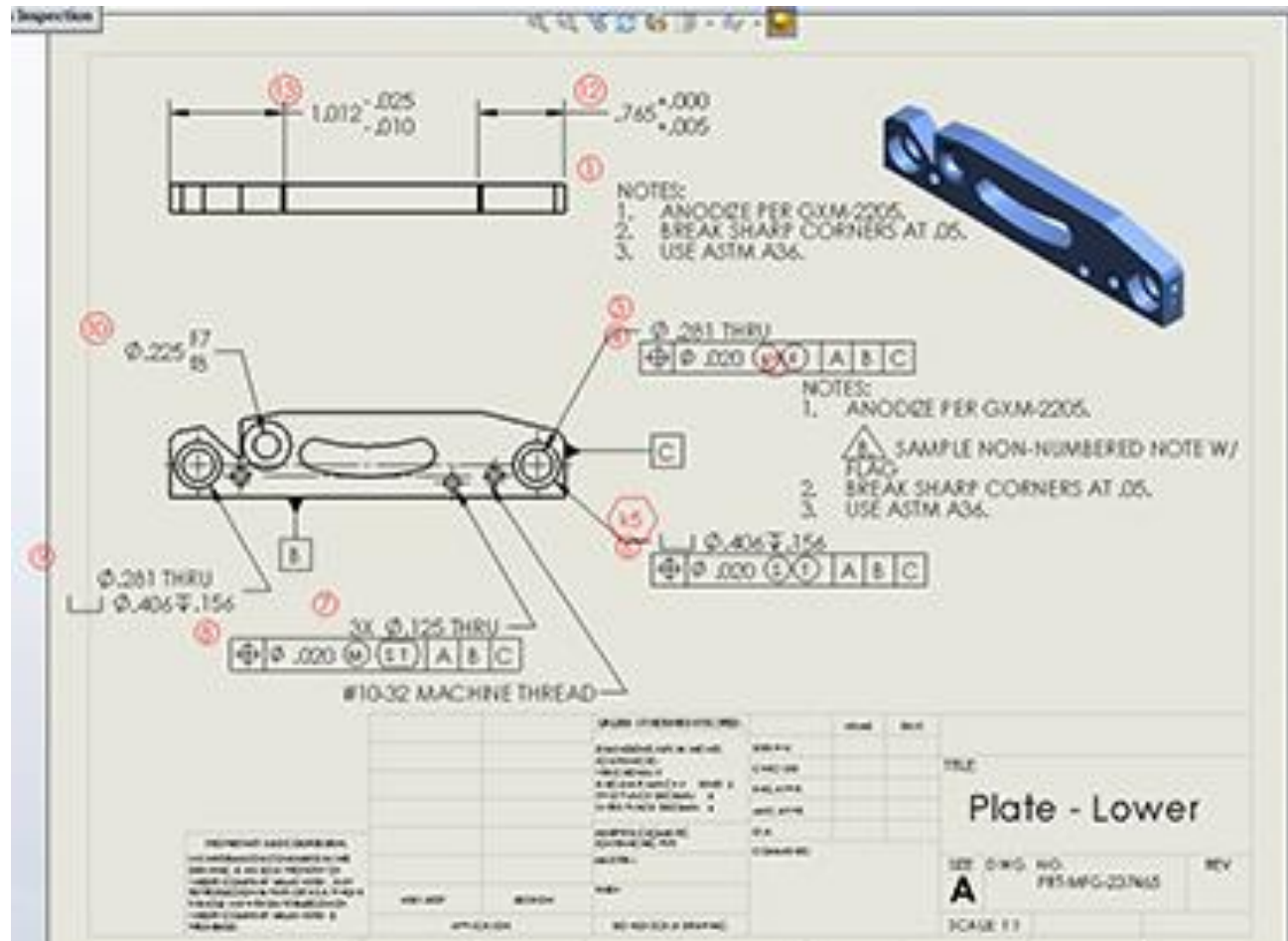

Term: Annotation

Definition: Explanatory notes added to a drawing.

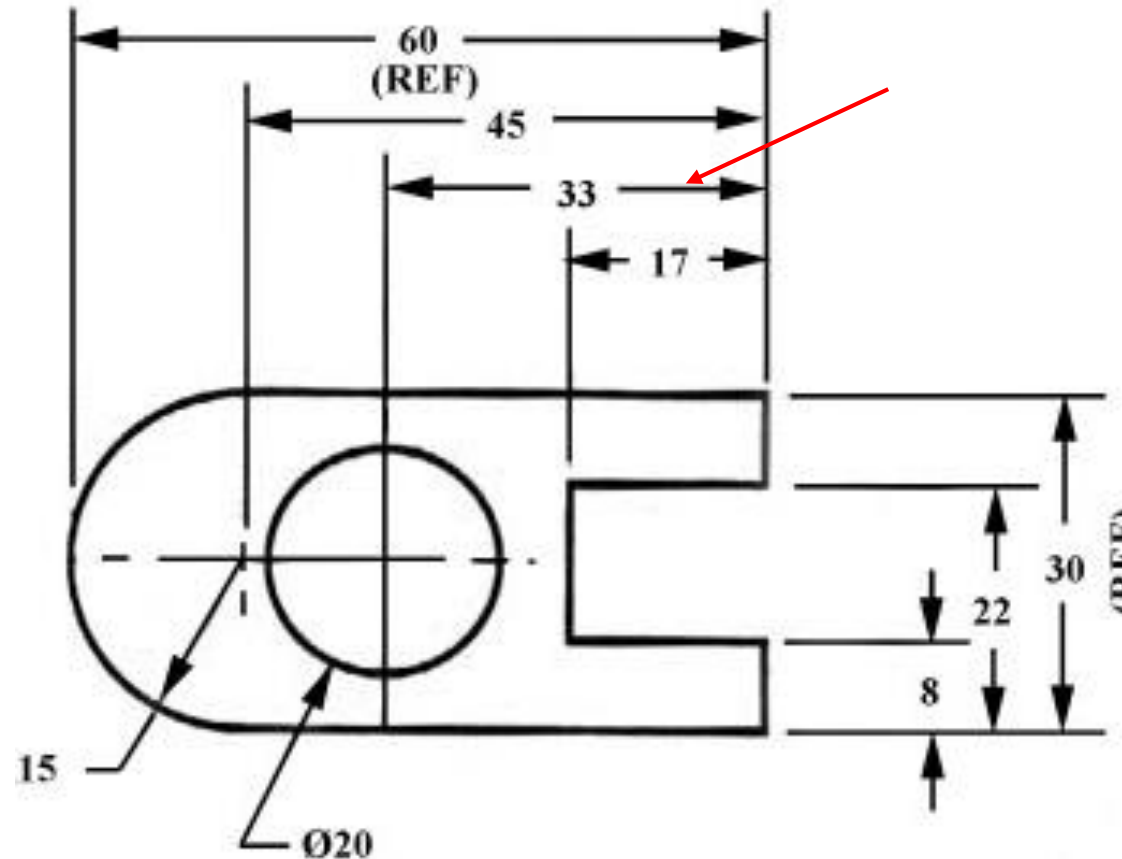

Term: Dimension Line

Definition: Thin lines capped with arrowheads, which may be broken along their length to provide space for the dimension numerals.

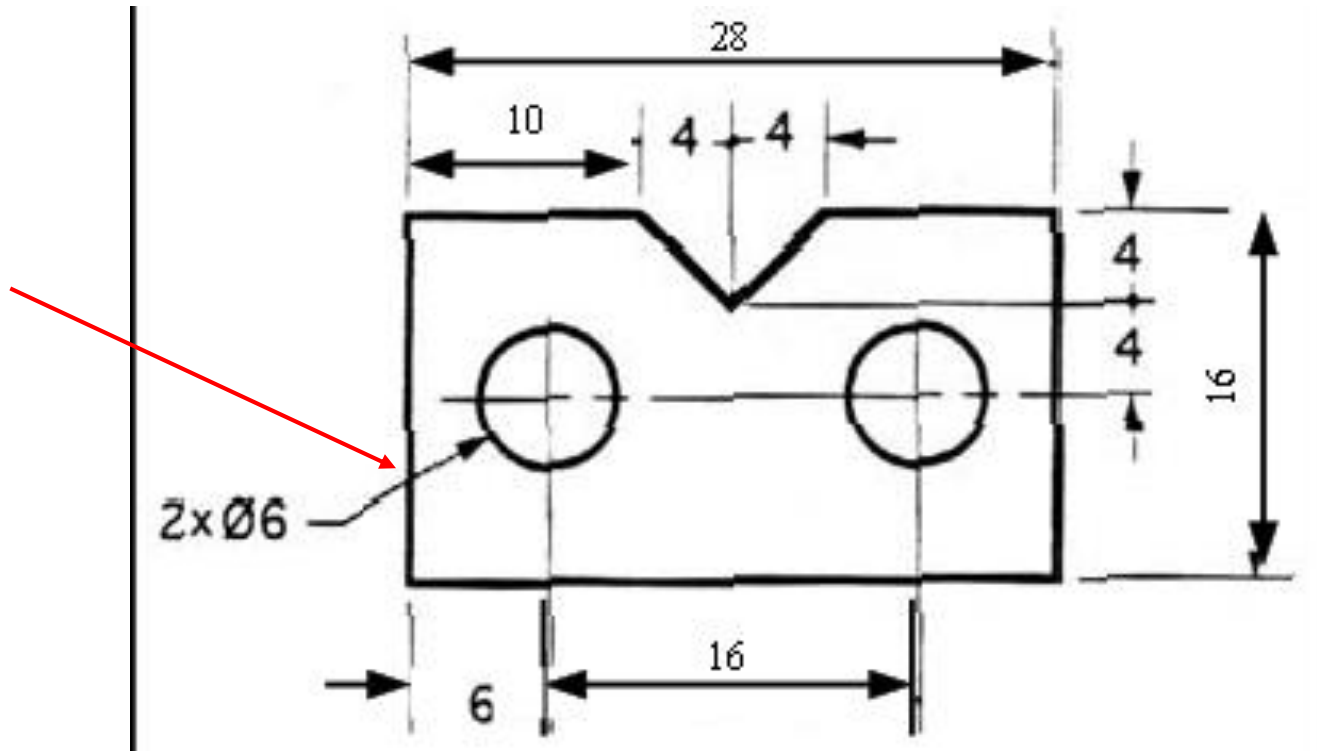

Term: Leader Line

Definition: Lines that are thin and used to connect a specific note to a feature.

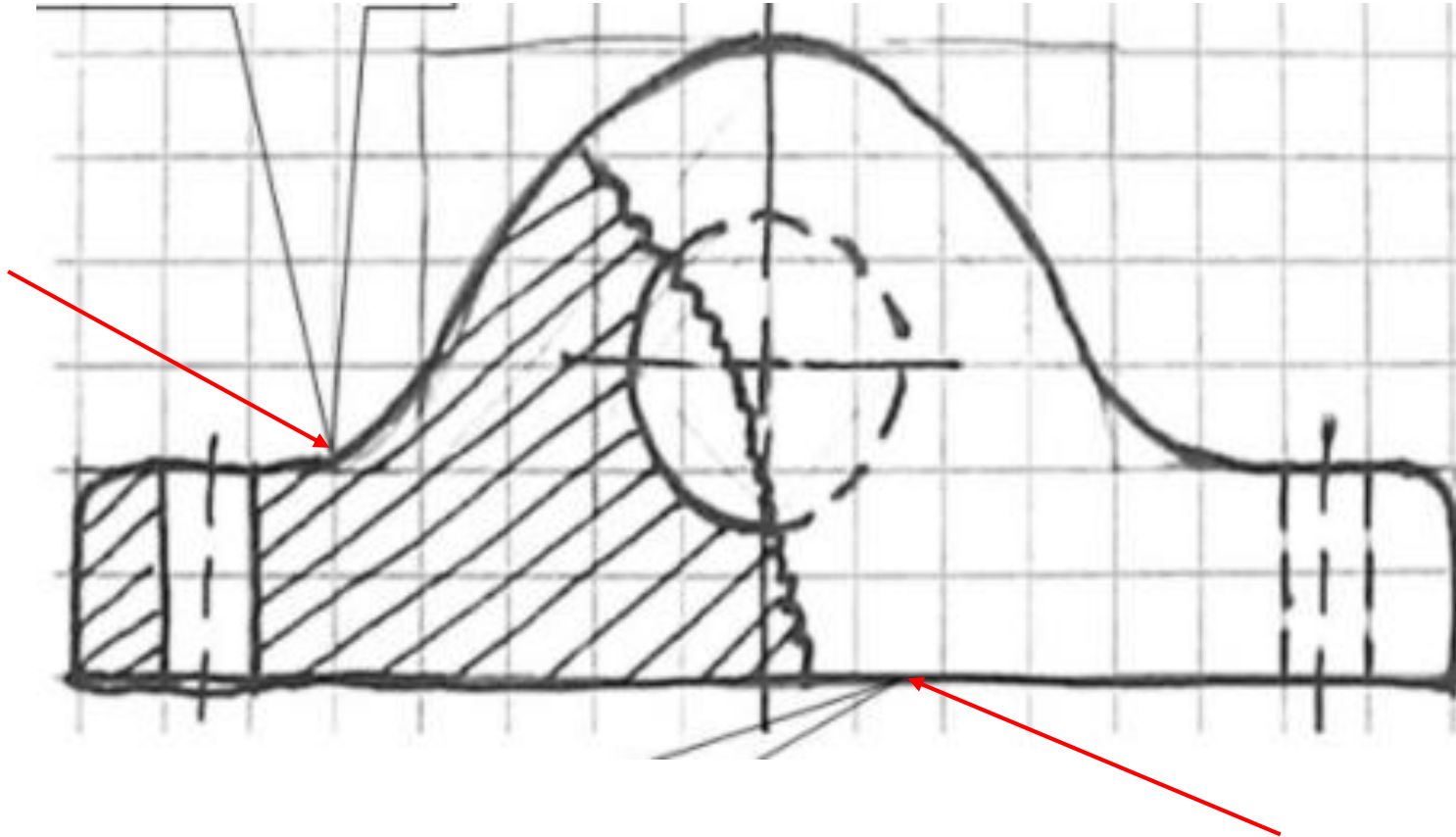

Term: Object Line

Definition: A heavy solid line used on a drawing to represent the outline of an object.



Term: Scale

Definition: A proportion between two sets of dimensions used in developing accurate, larger or smaller prototypes, or models of design ideas.

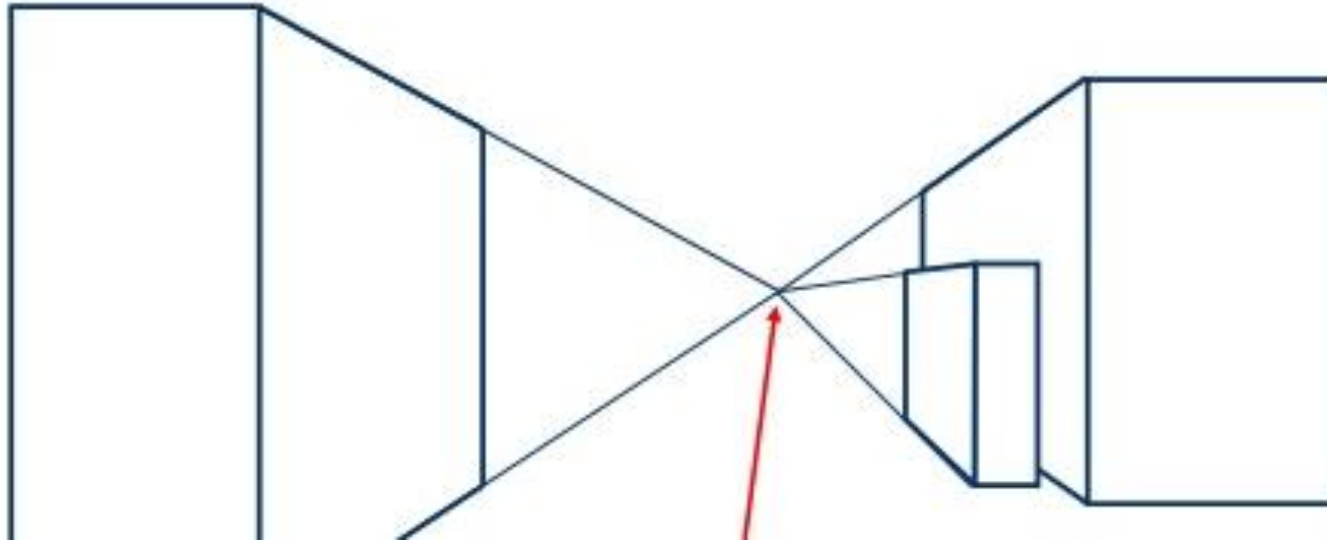

Term: Vanishing Point

Definition: A point in space, usually located on the horizon, where parallel edges of an object appear to converge.

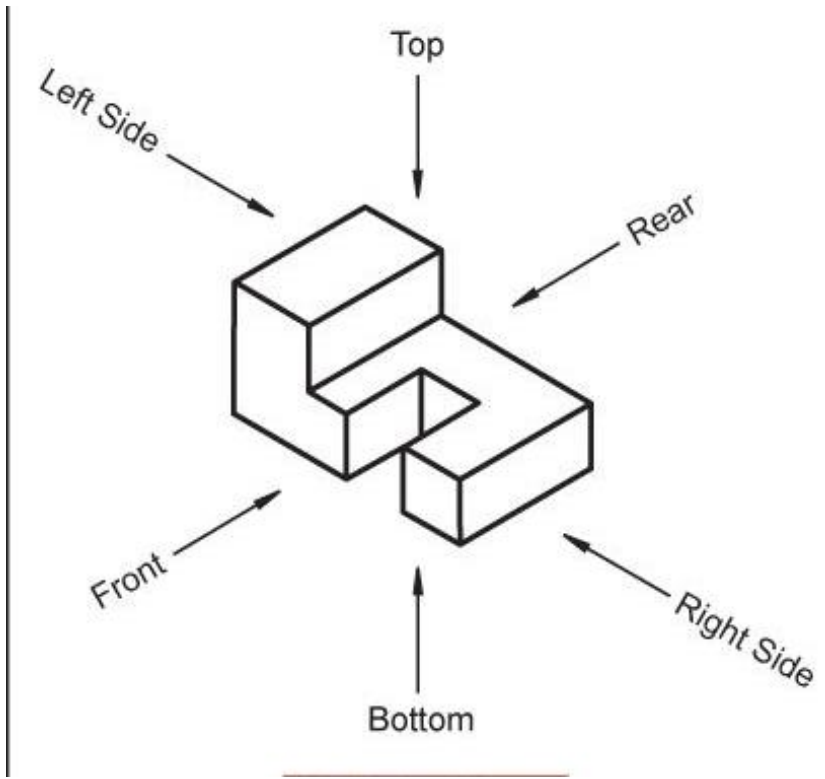

Term: Views

Definition: This is multiview projection, which is a system used to view an object. The six mutually perpendicular directions any object may be viewed are top, front, right-side, rear, left-side, and bottom. Top, front, and right-side views are also referred to as the three regular views because they are the three views most frequently used.

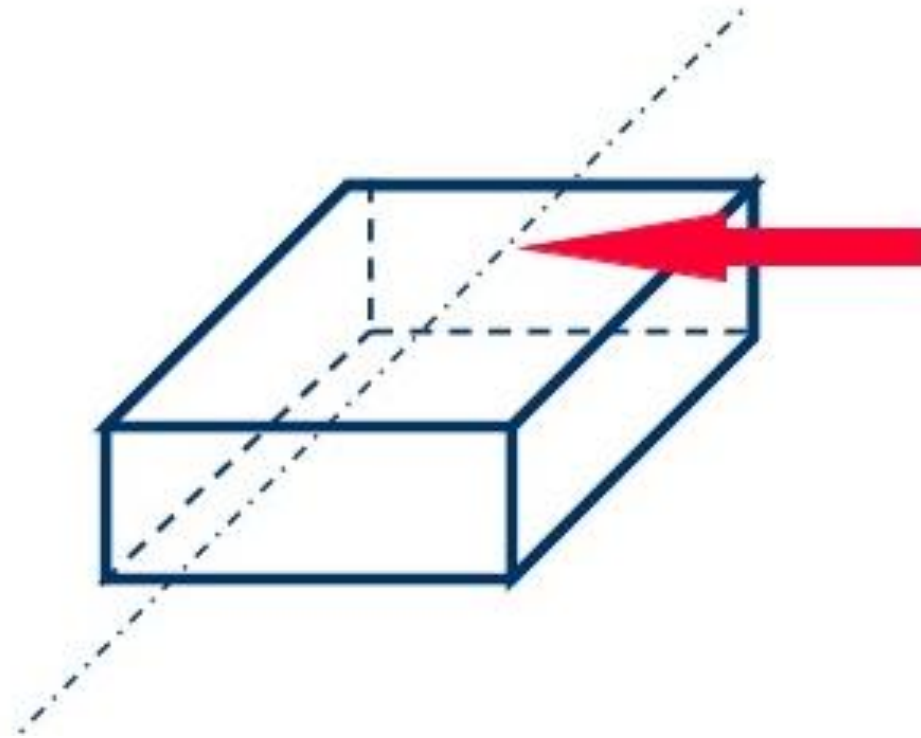

Term: Center Line

Definition: A line type that is used to indicate the axis of symmetry for a part or feature.

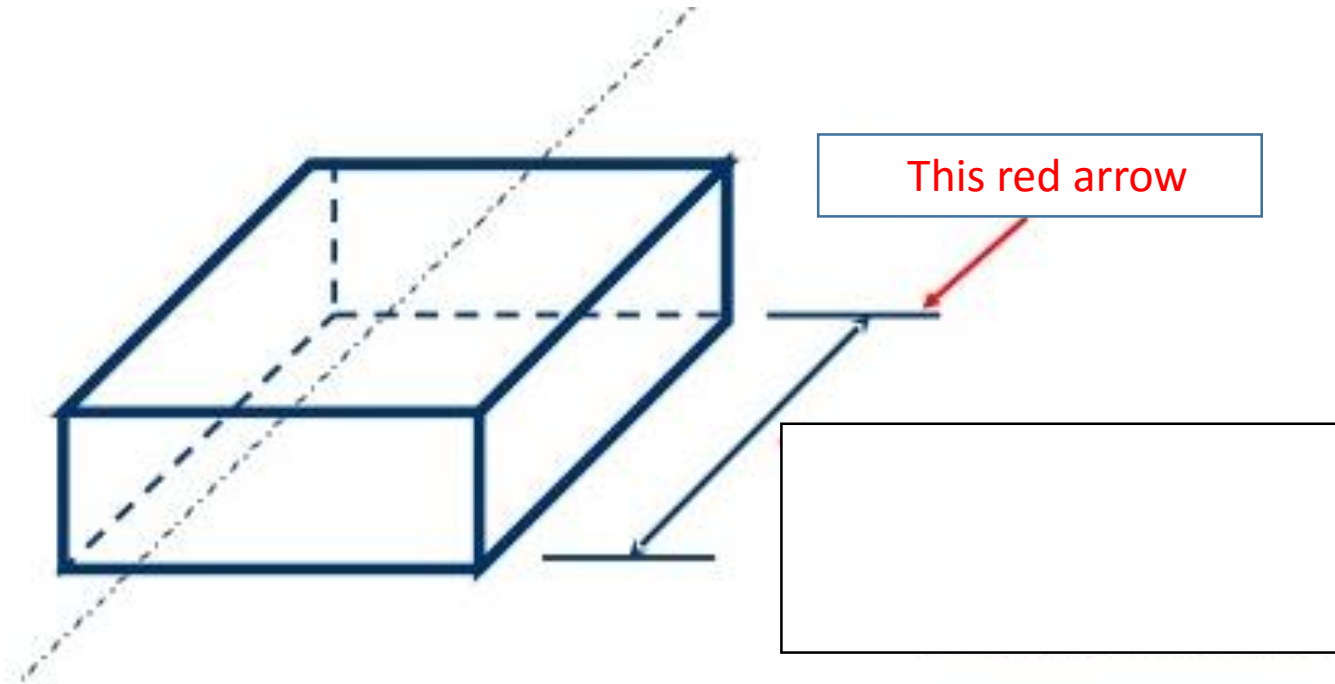

Term: Extension Line

Definition: A thin solid line perpendicular to a dimension line, indicating which feature is associated with the dimension.

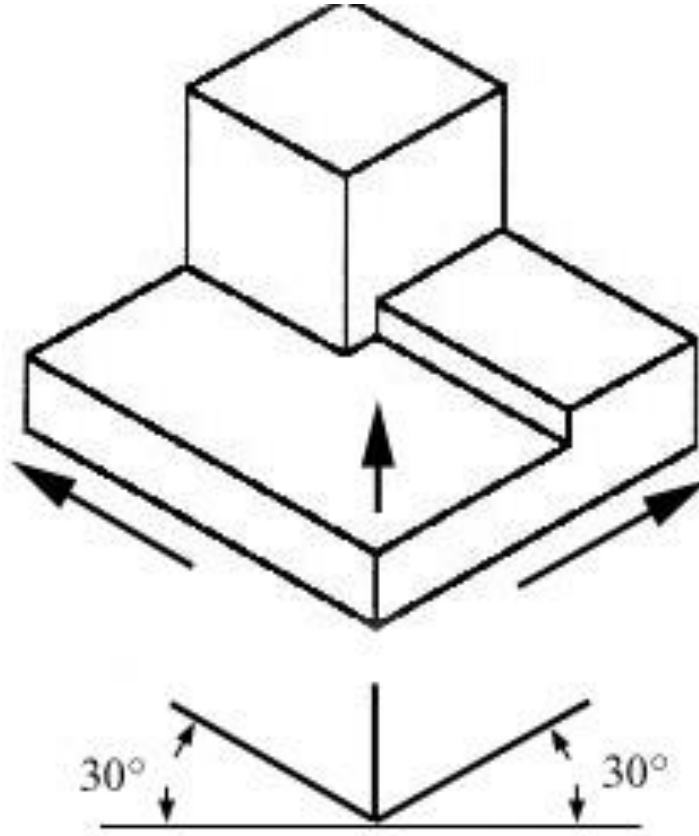

Term: Isometric

Definition: A form of pictorial drawing in which all three drawing axes form equal angles of 120 degrees with the plane of projection.

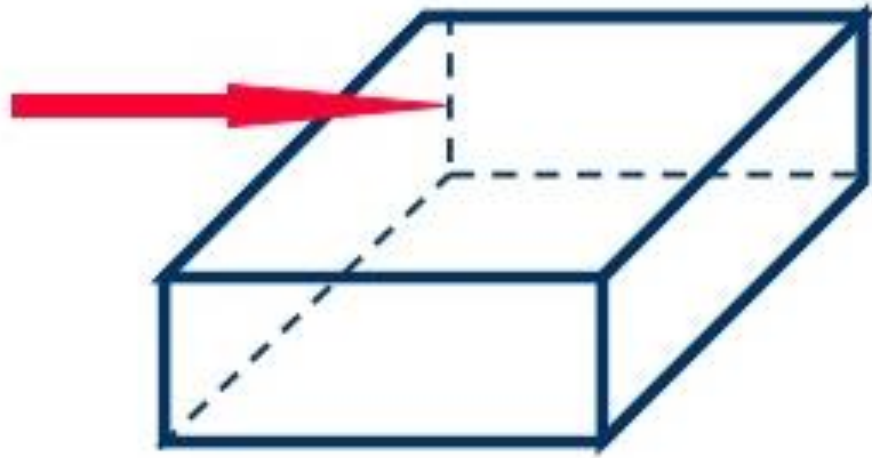

Term: Hidden Line

Definition: A line type that represents an edge that is not directly visible because it is behind or beneath another surface.

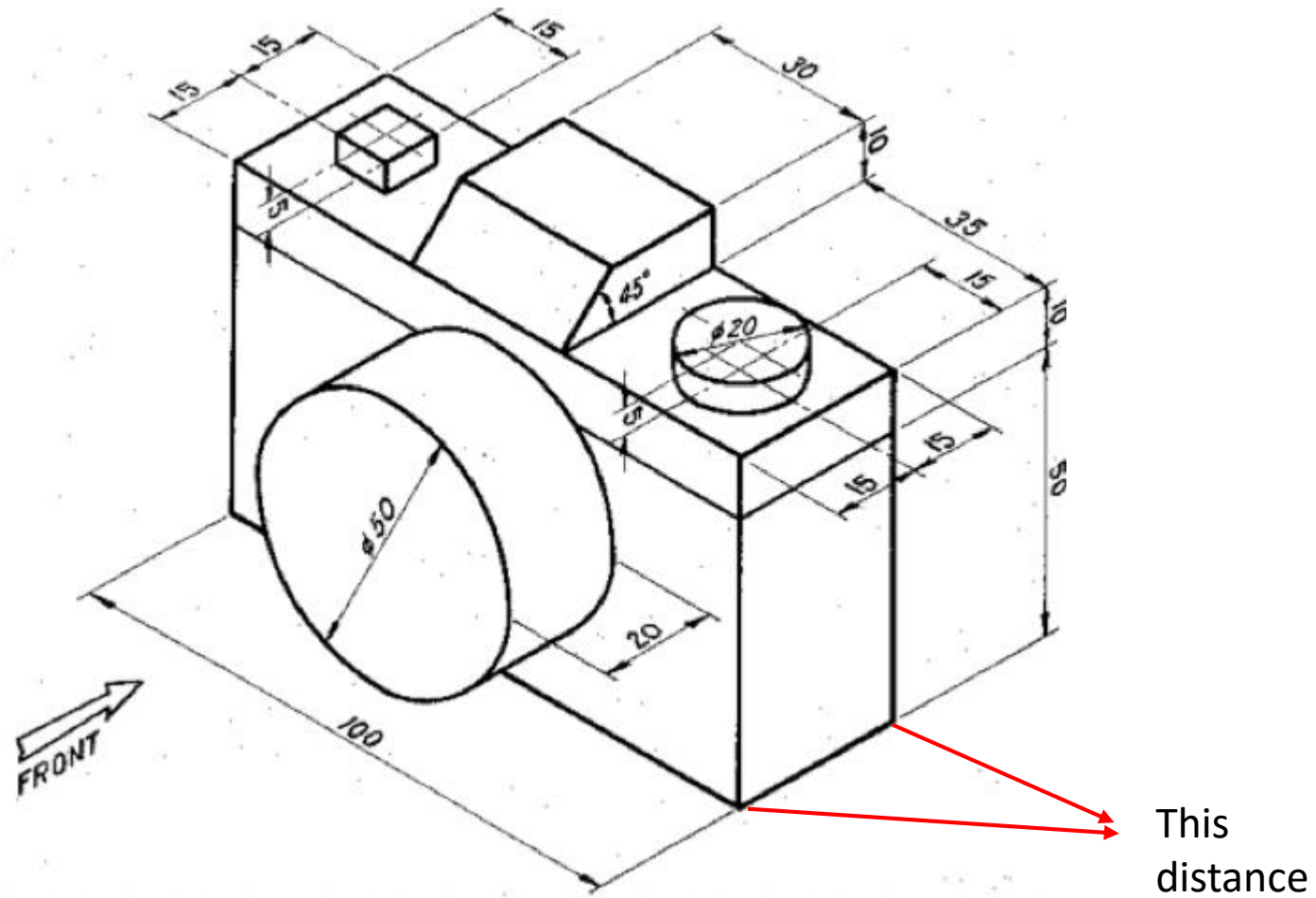

Term: Depth

Definition: The distance from front to back.

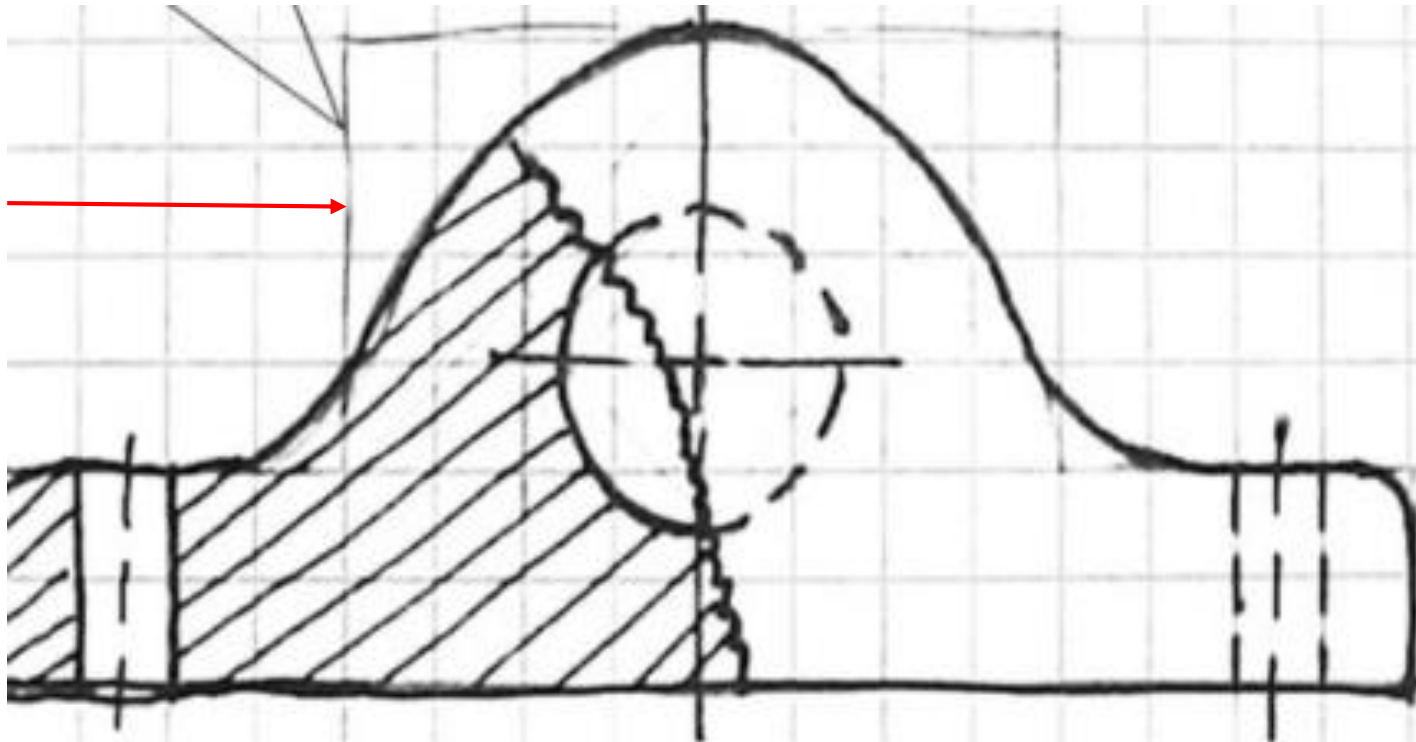

Term: Construction Line

Definition: Thin lines that serve as guides while sketching or drawing.

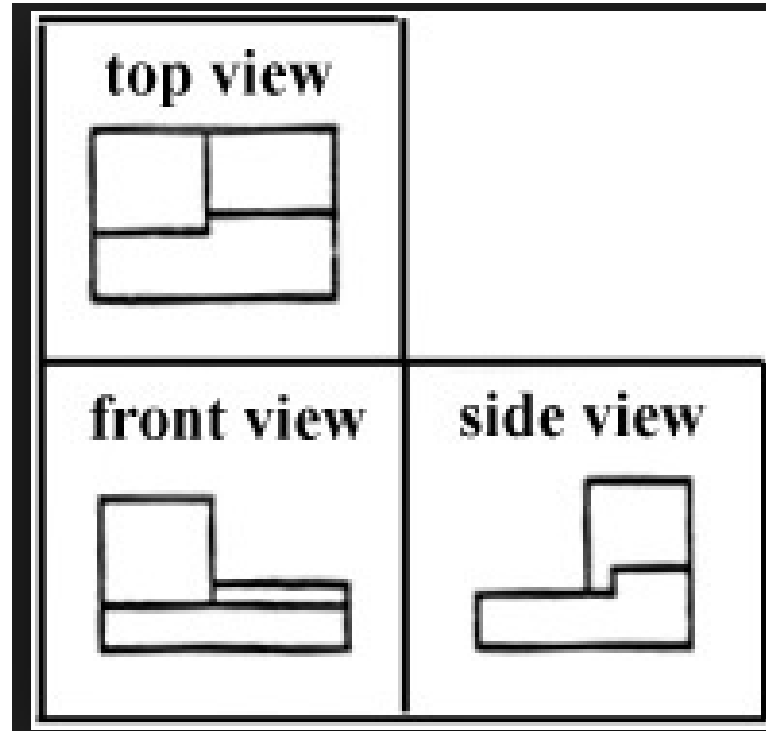

Term: Orthographic Projection

Definition: A method of representing three-dimensional objects on a plane having only having 2 dimensions

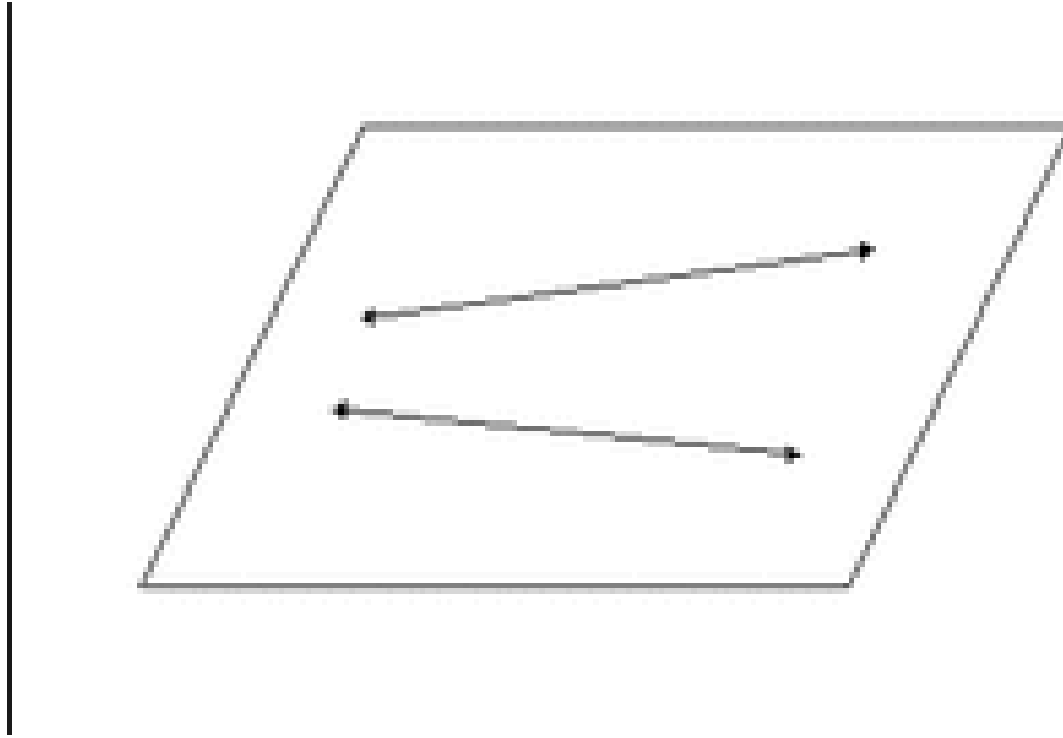

Term: Plane

Definition: A flat surface on which a straight line joining any two points would wholly lie.



Term: Three Dimensional

Definition: Having the dimensions of height, width, and depth.

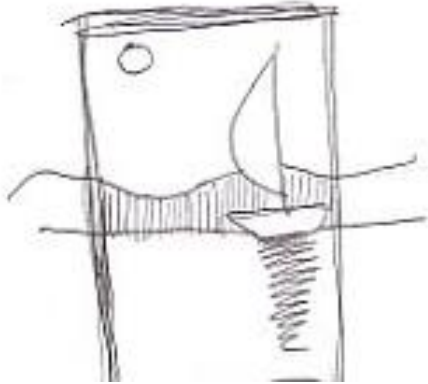
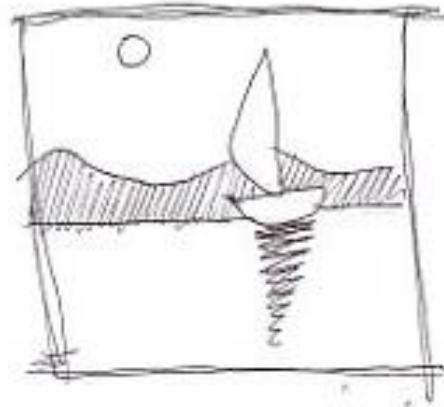
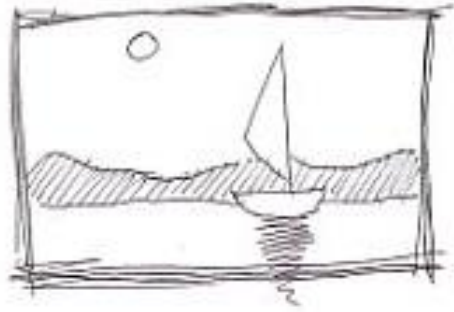

Term: Thumbnail Sketch

Definition: A preliminary visual of a possible idea for a design. These sketches are not full-size and have little detail. They are intended to quickly explore possible alternative designs.



Term: 2-Point Perspective

Definition: A realistic way of drawing objects in three dimensions using a horizon line, a key edge, and two vanishing points.

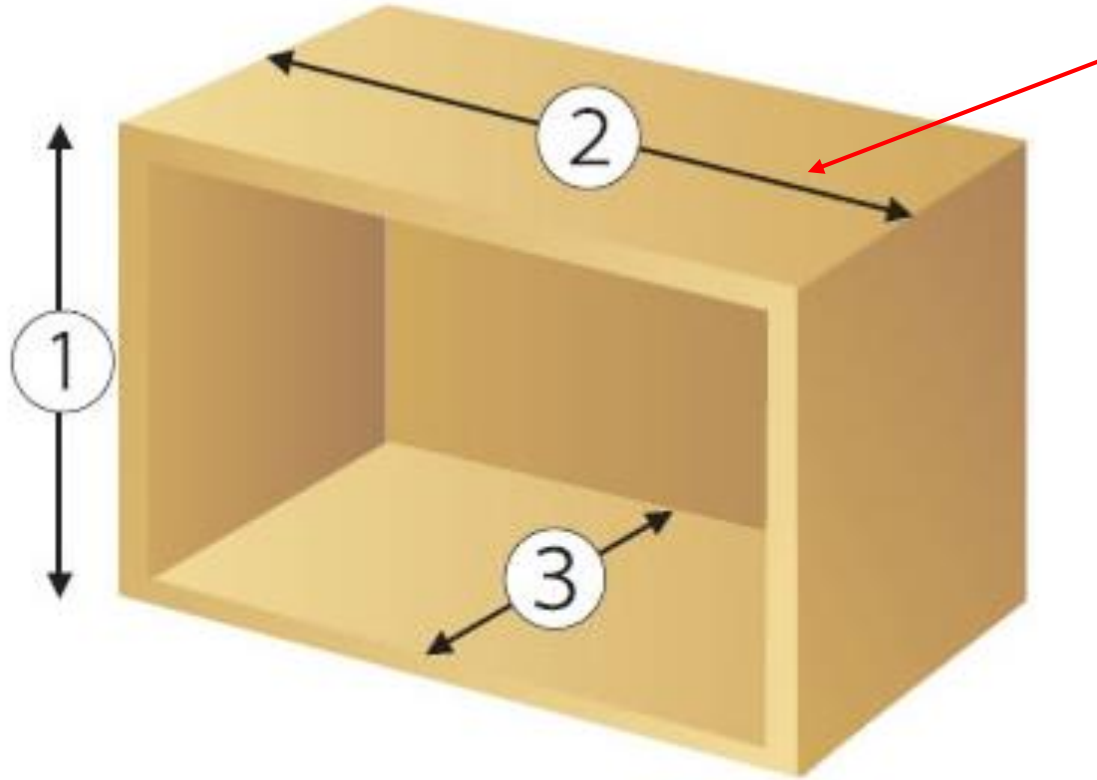

Term: Width

Definition: The measurement or extent of something from side to side.

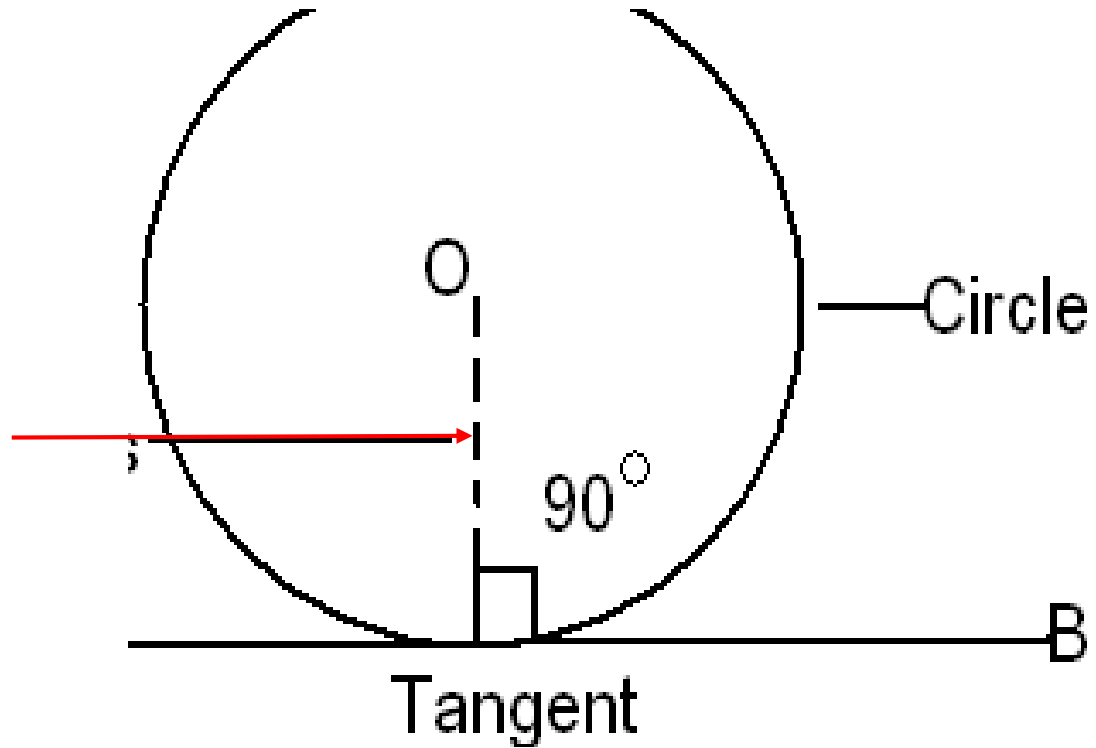

Term: Radius

Definition: A straight line from the center to the circumference of a circle or sphere.

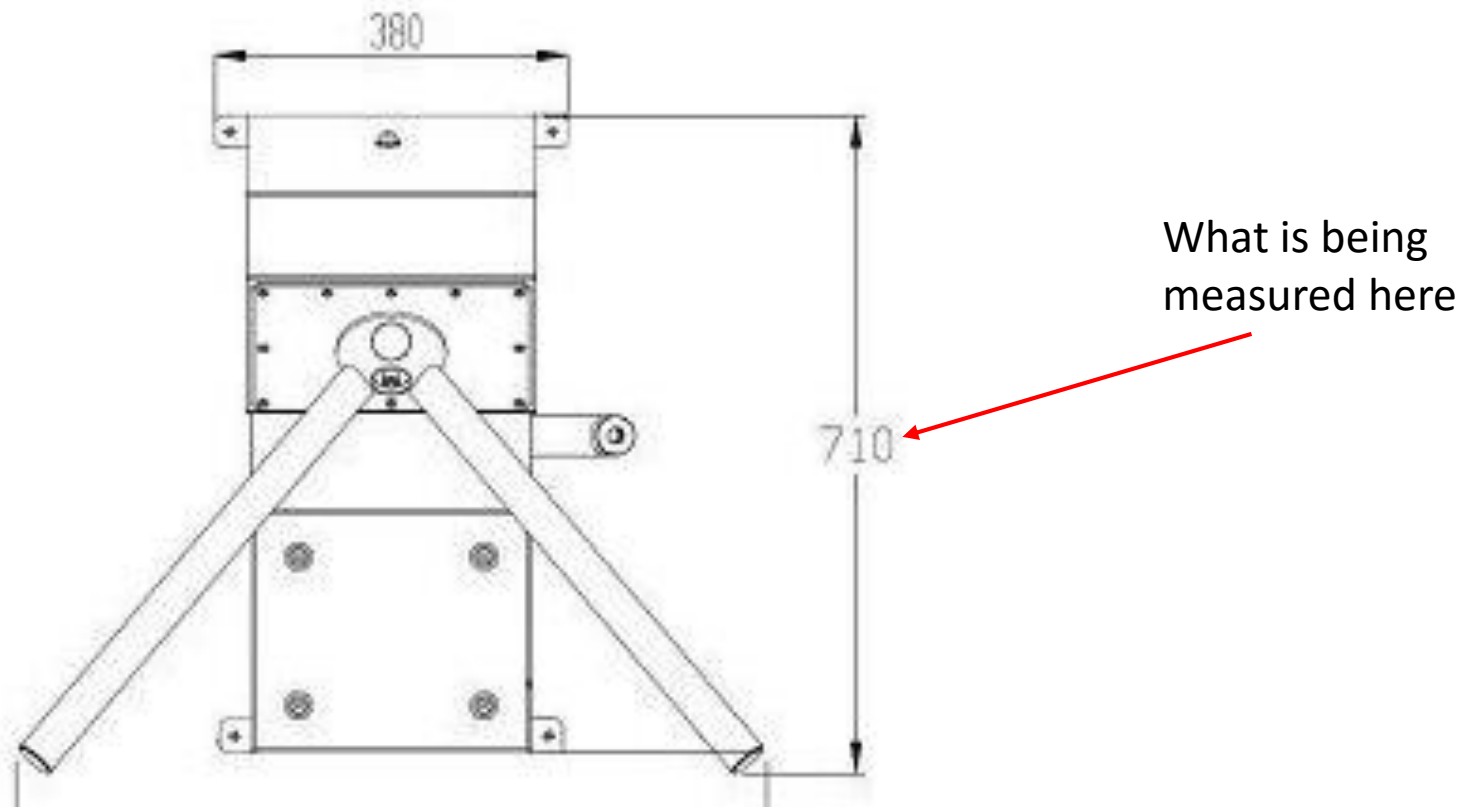

Term: Height

Definition: The measurement of someone or something from head to foot or from base to top.

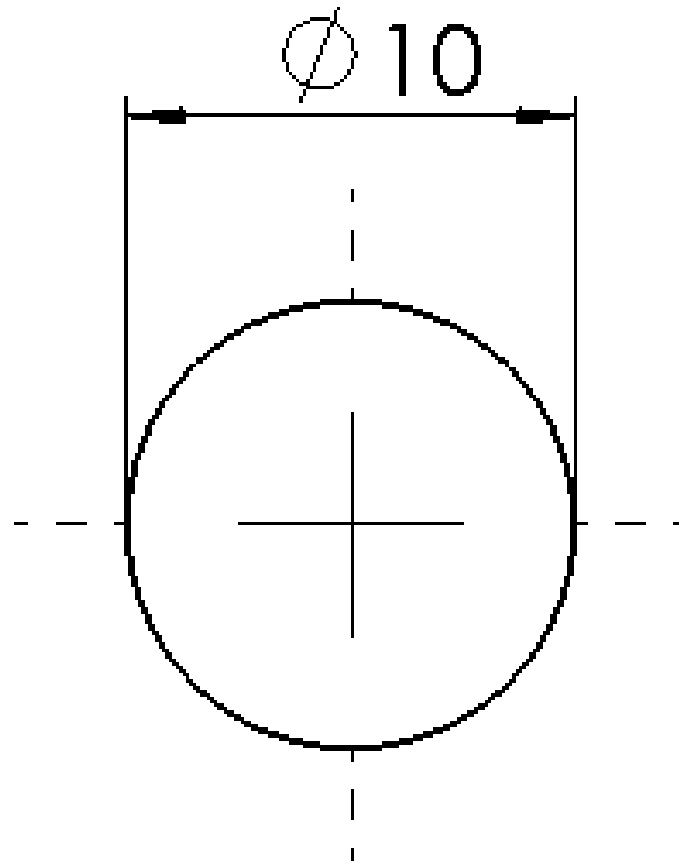

Term: Diameter

Definition: A straight line passing from side to side through the center of a circle or sphere.

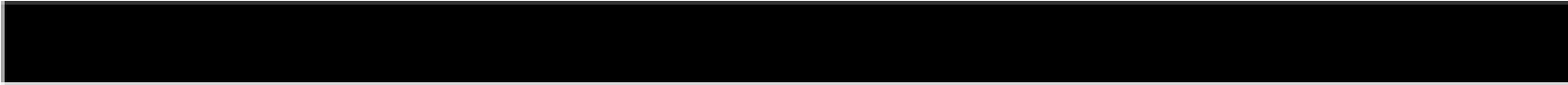

Term: Line Weight

Definition: Also called line width. The thickness of a line, characterized as thick or thin.



Term: 1-Point Perspective

Definition: A method of realistic drawing in which the part of an object closest to the viewer is a planar face, and all the lines describing sides perpendicular to that face can be extended back to converge at one point, the vanishing point